

PIANO UNDICESIMO

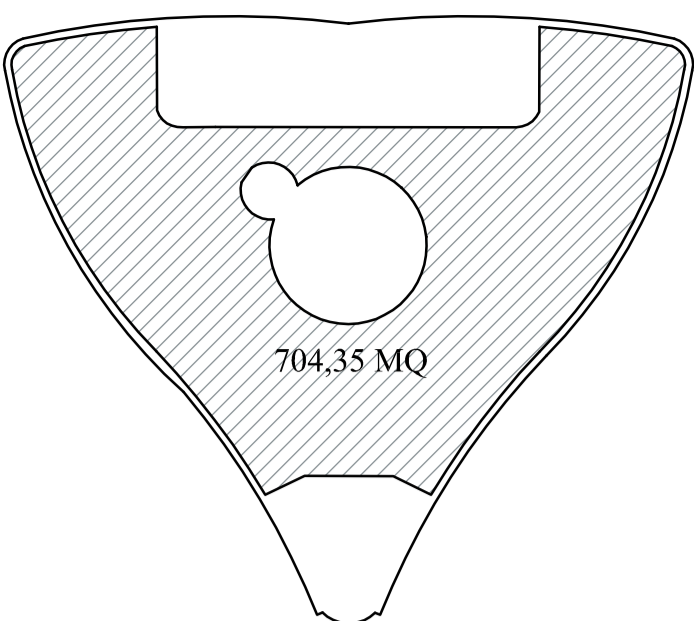

PIANO QUATTORDICESIMO

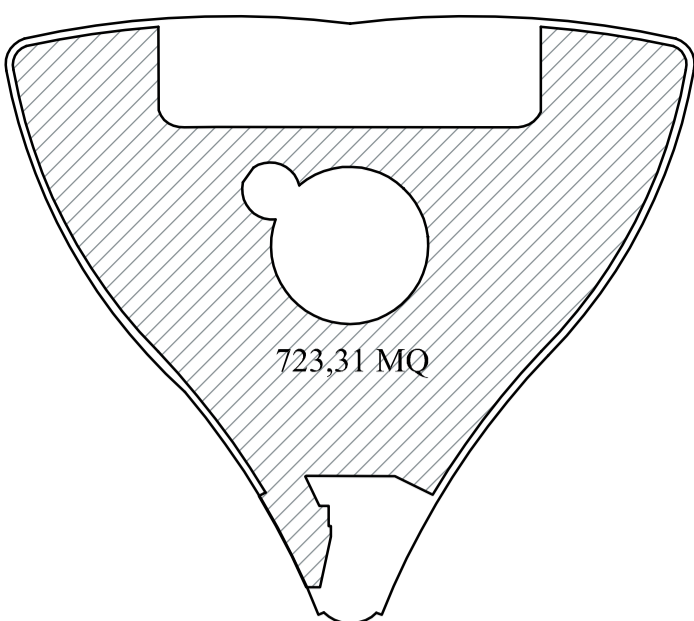

PIANO SEDICESIMO

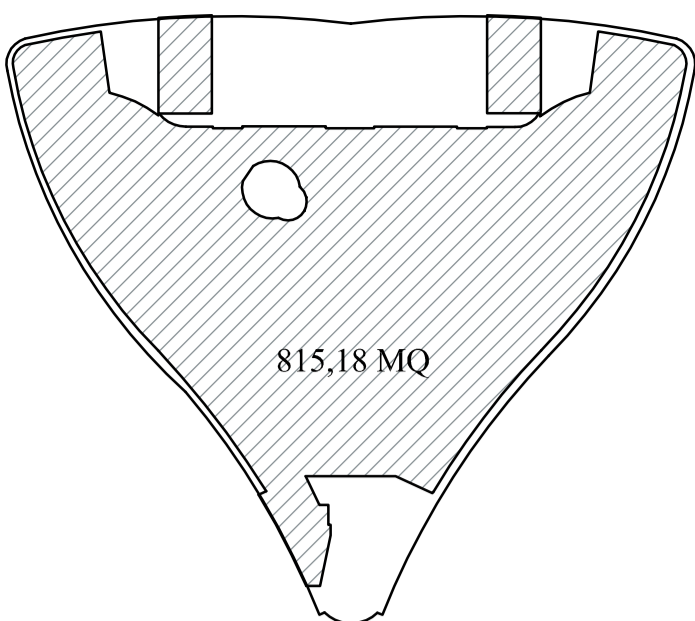

PIANO DICIANNOVESIMO

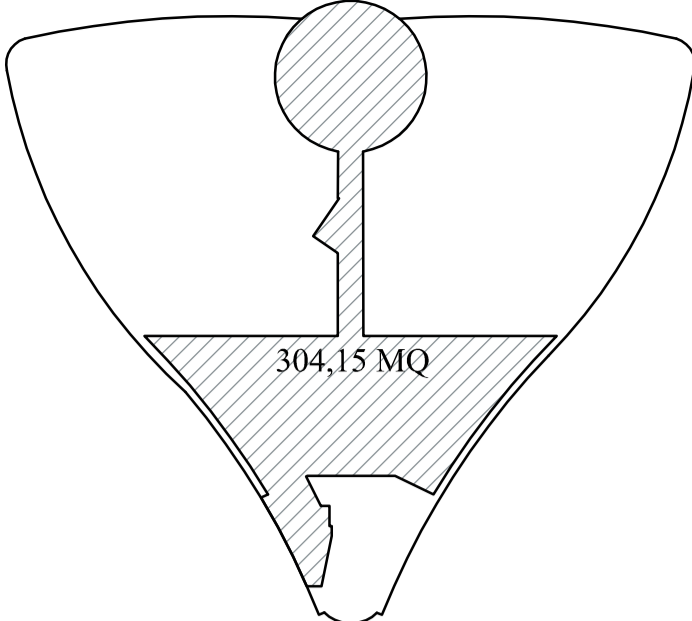

PIANO VENTESIMO

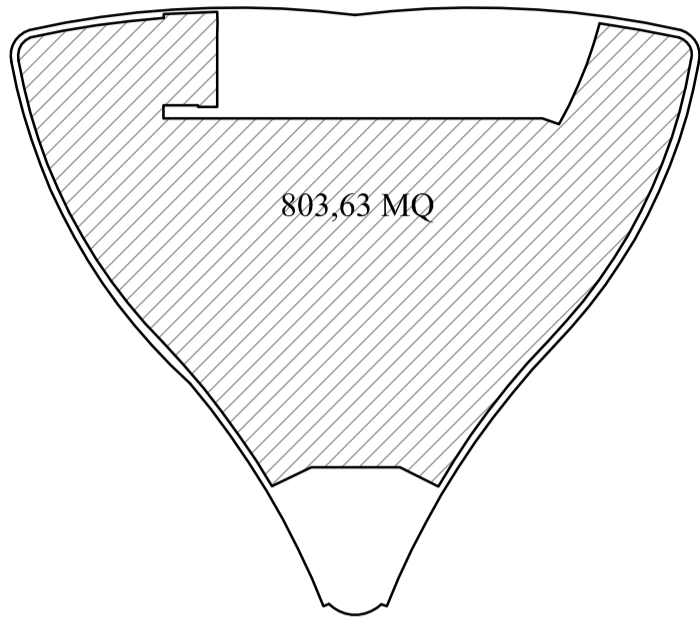

PIANO DECIMO

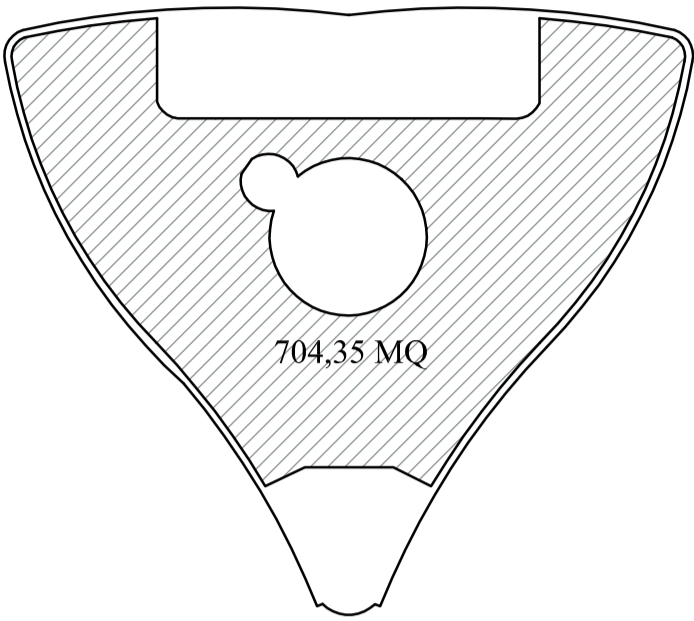

PIANO DODICESIMO

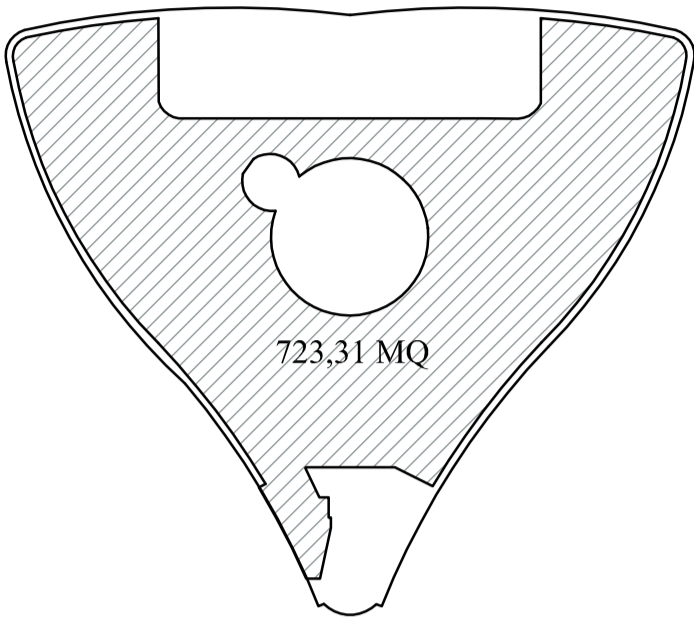

PIANO QUINDICESIMO

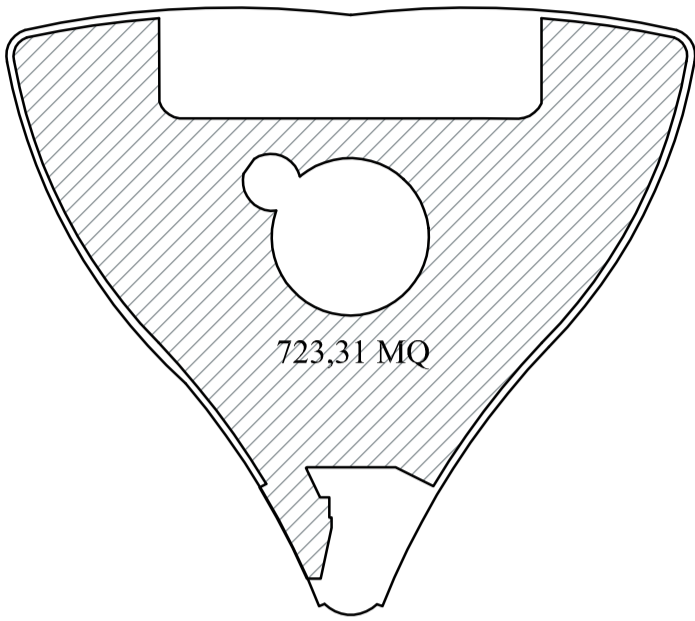

PIANO DICIOTTESIMO

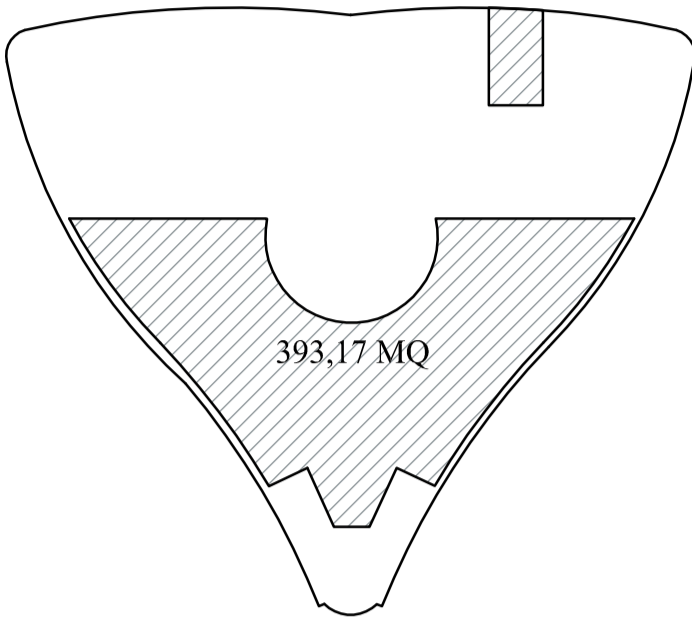

PIANO VENTESIMO

PIANI RICETTIVI - ALBERGO

PIANI COMMERCIALI

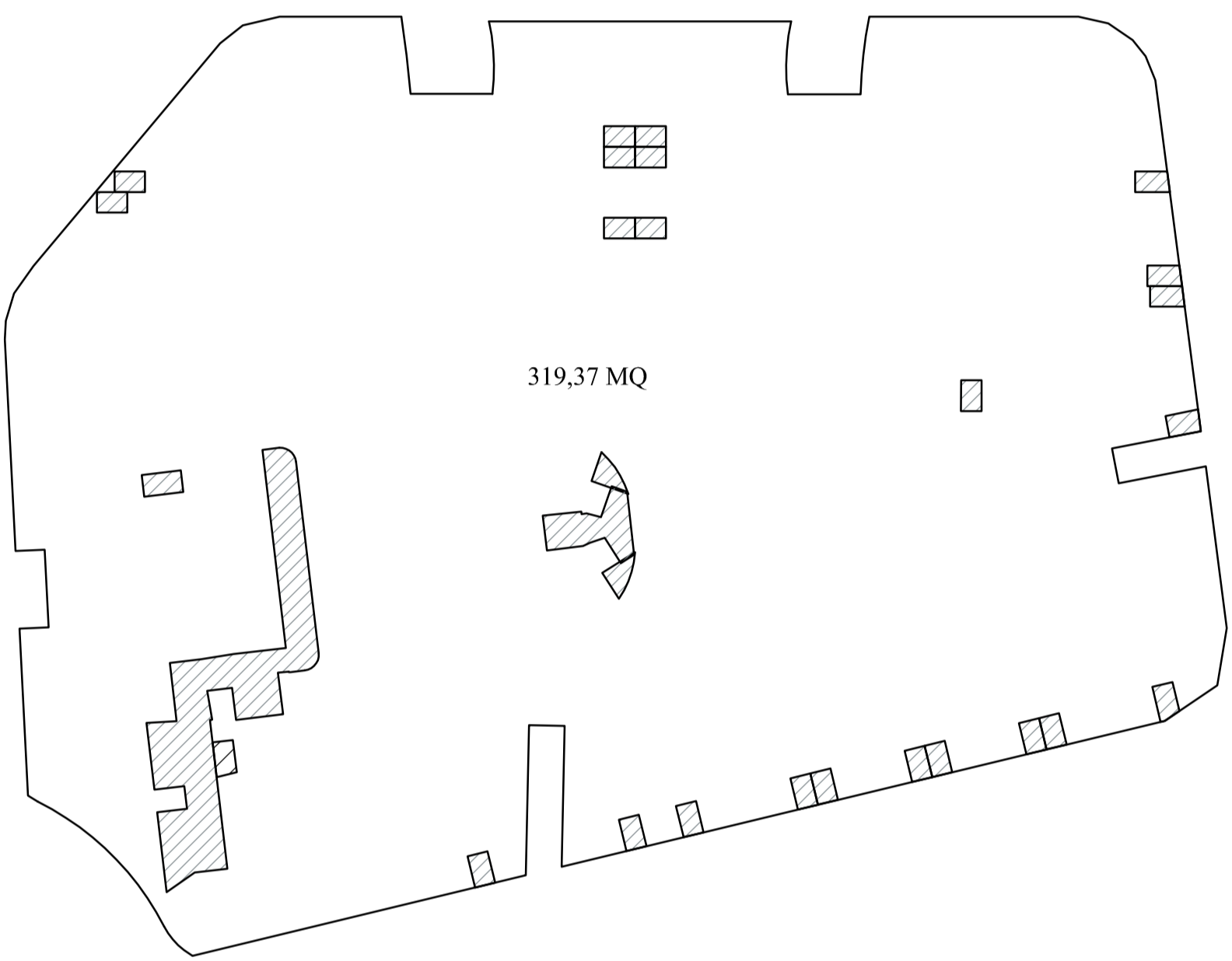

PIANO TERRA - LIVELLO SOPPALCHI

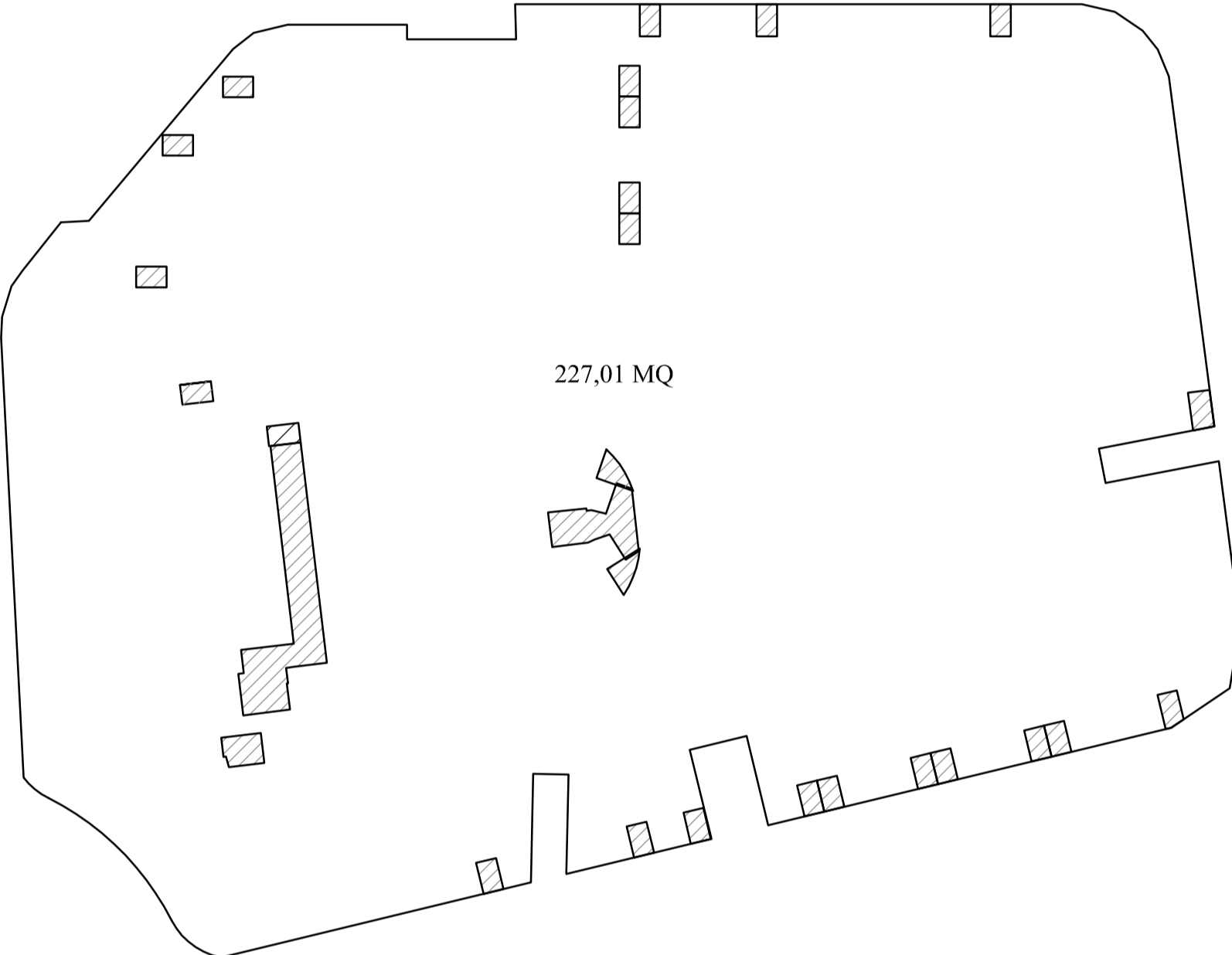

PIANO PRIMO - LIVELLO SOPPALCHI

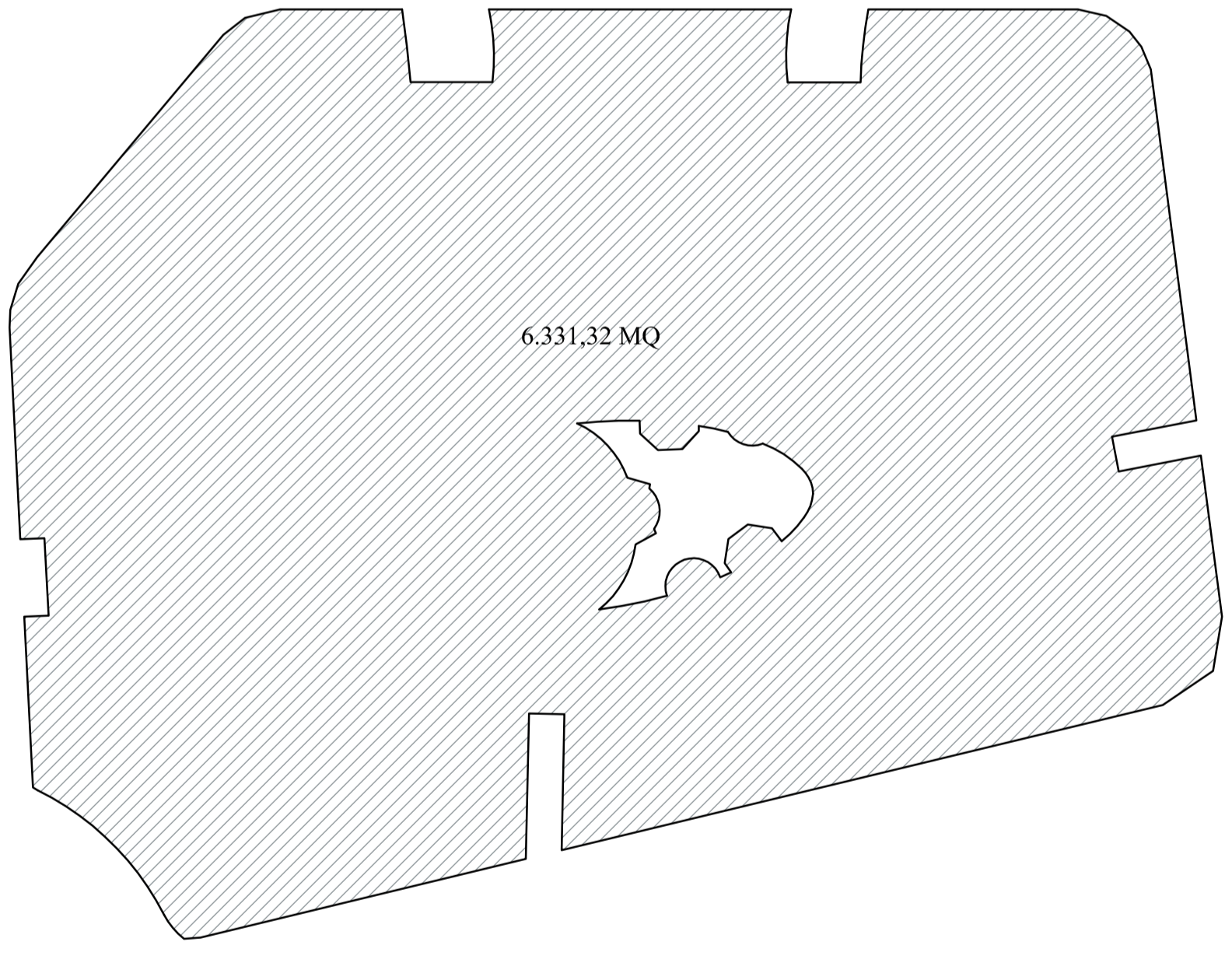

PIANO TERRA

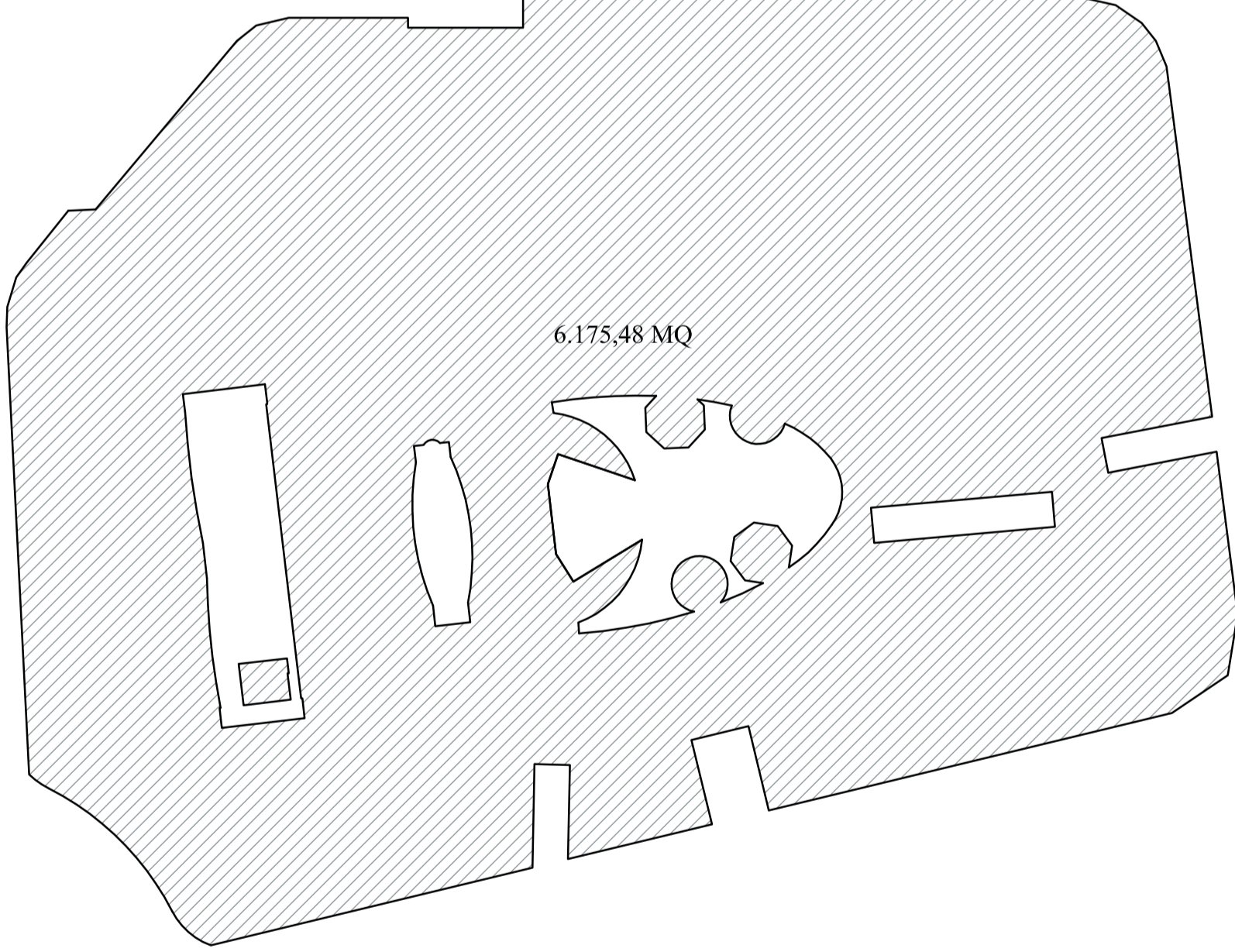

PIANO PRIMO

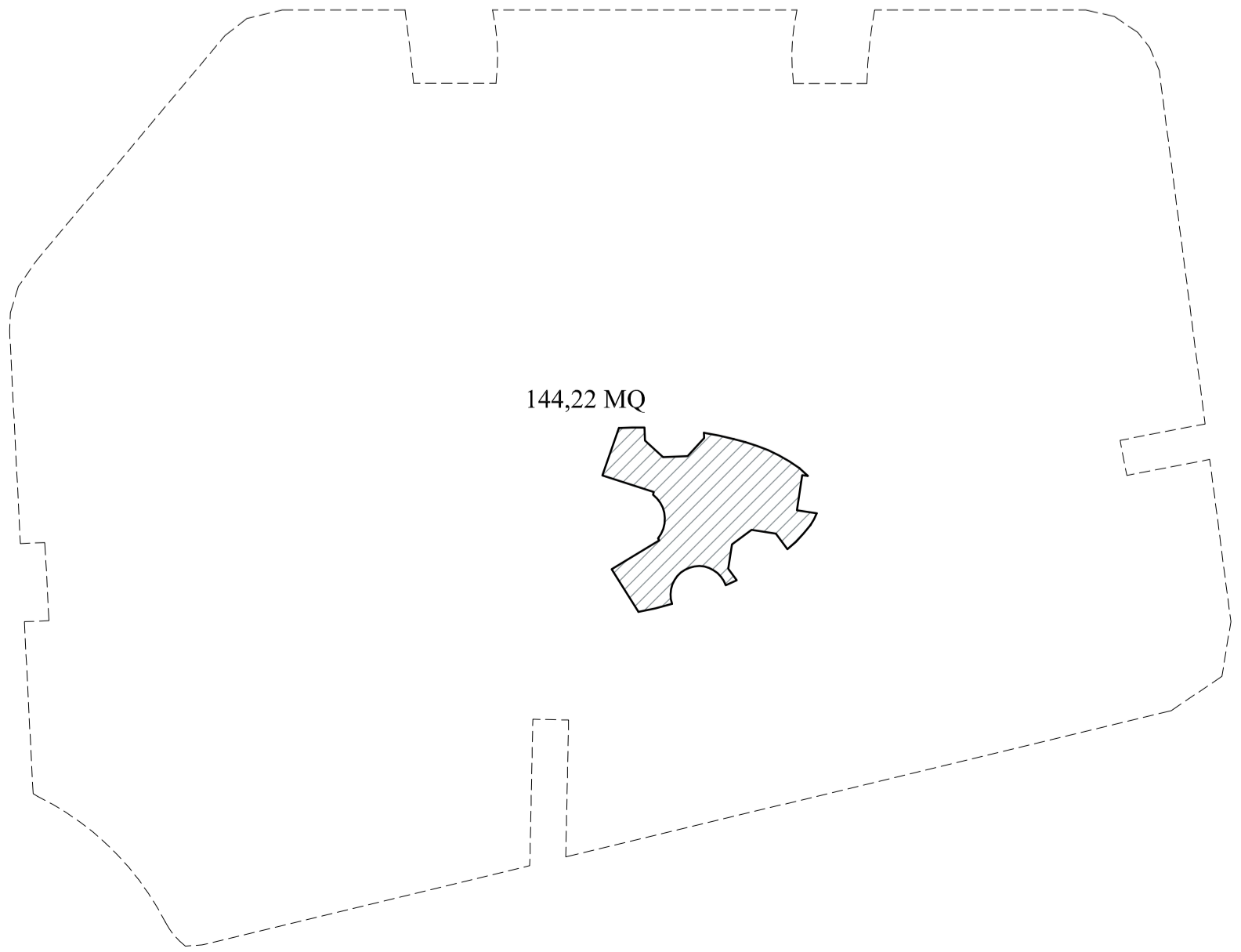

PIANO SEMINTERRATO

PIANI PUBBLICO ESERCIZIO - RISTORANTE

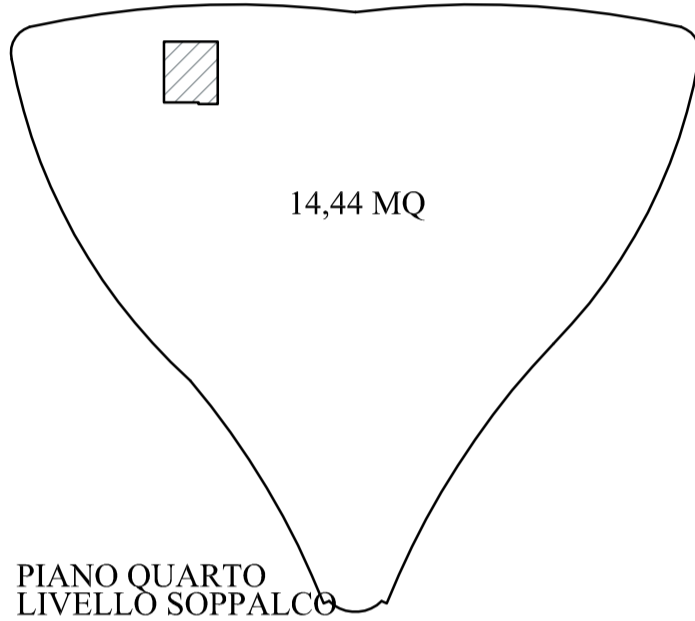

PIANO QUARTO  
LIVELLO SOPPALCO

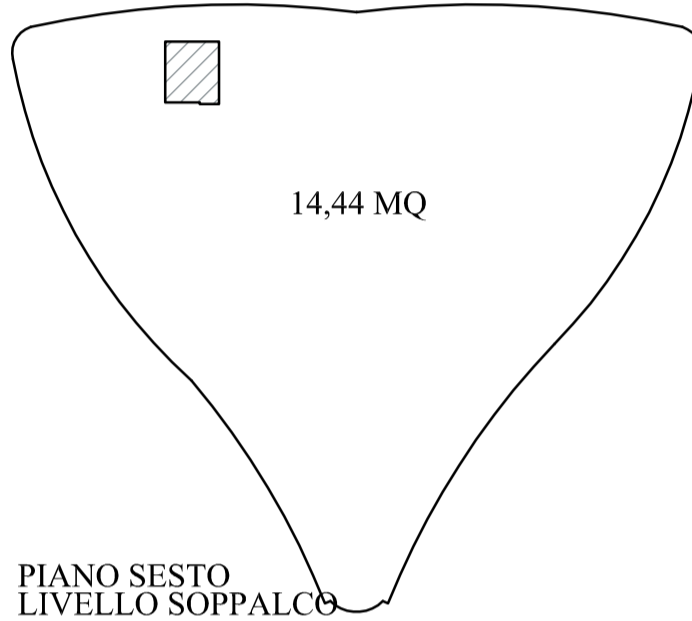

PIANO SESTO  
LIVELLO SOPPALCO

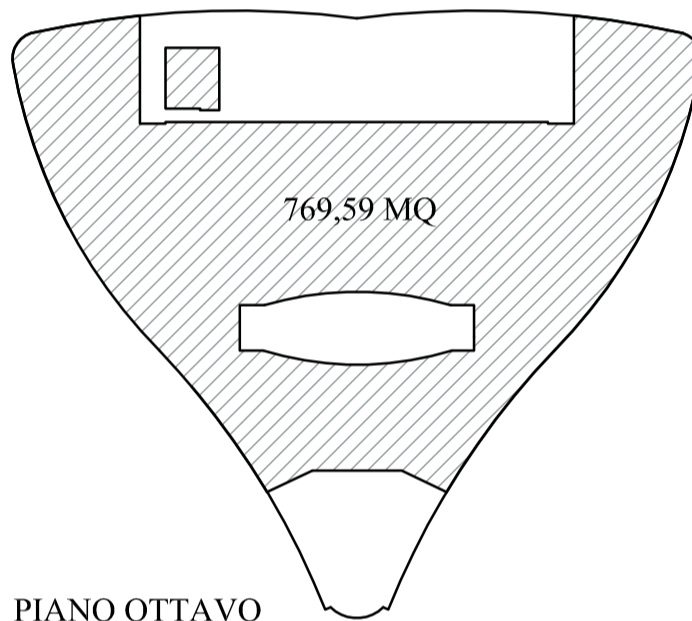

PIANO OTTAVO

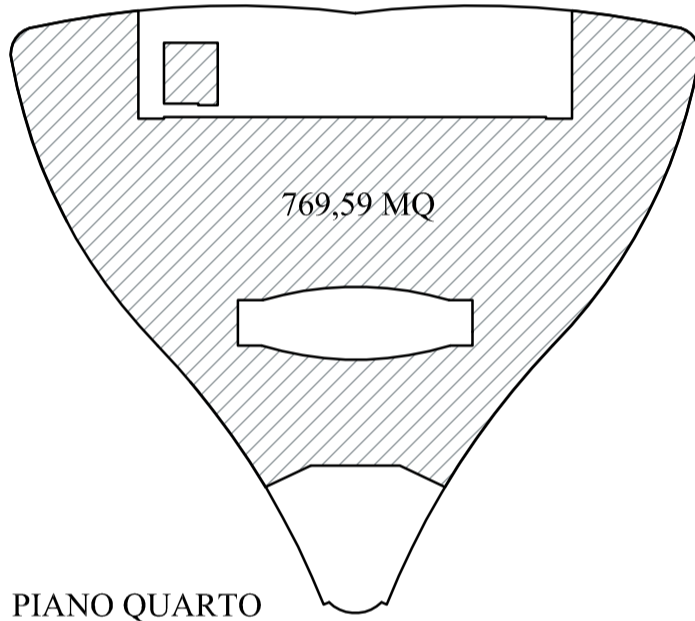

PIANO QUARTO

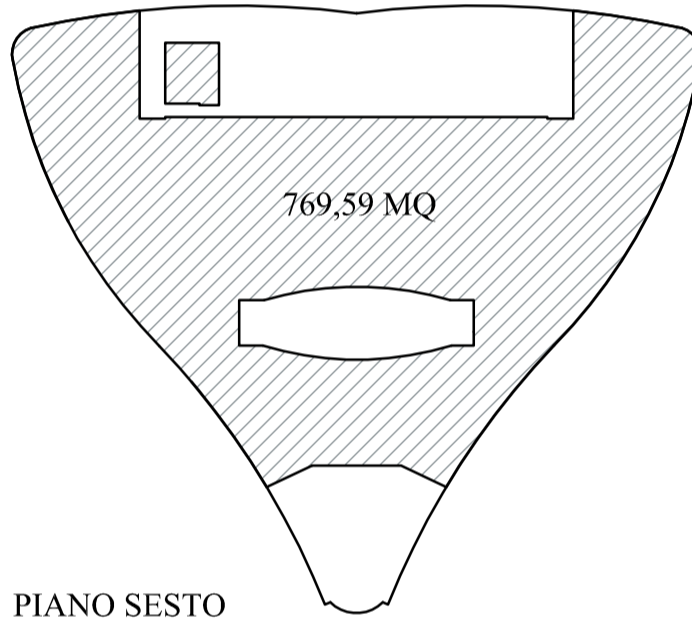

PIANO SESTO

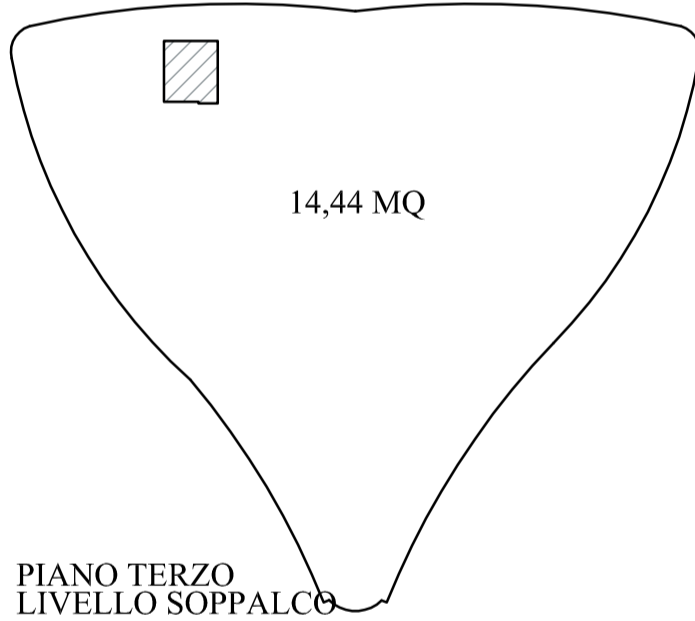

PIANO TERZO  
LIVELLO SOPPALCO

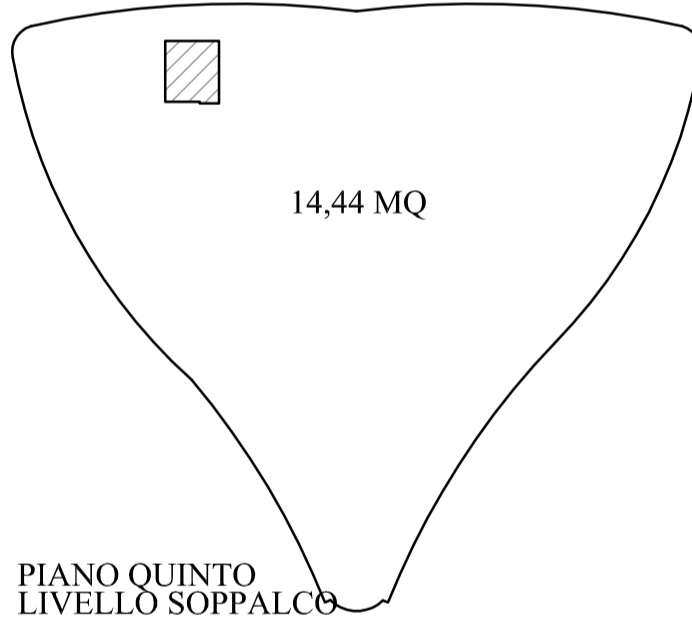

PIANO QUINTO  
LIVELLO SOPPALCO

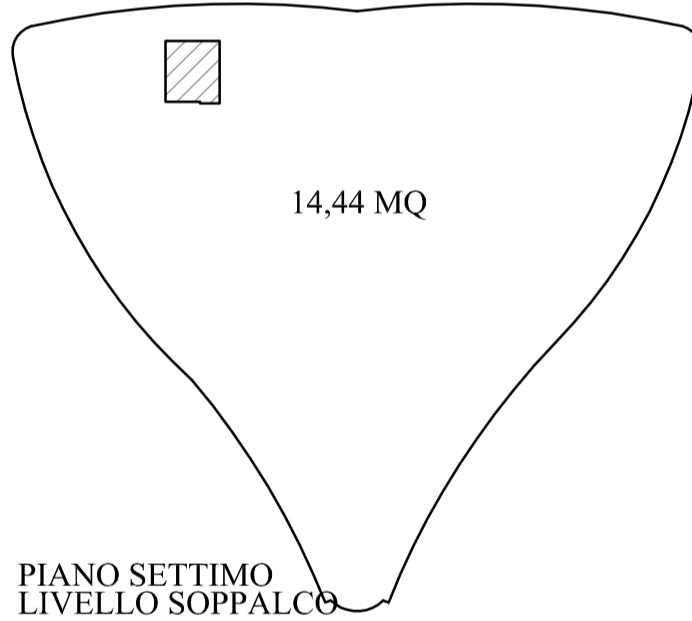

PIANO SETTIMO  
LIVELLO SOPPALCO

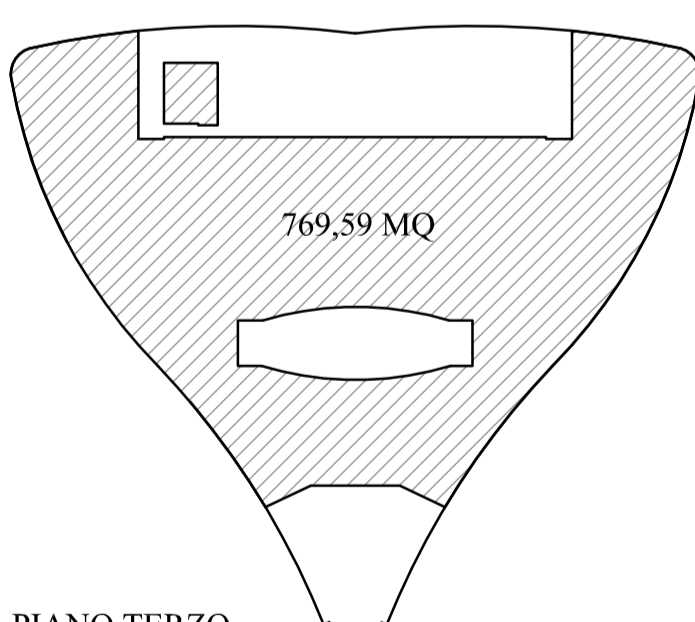

PIANO TERZO

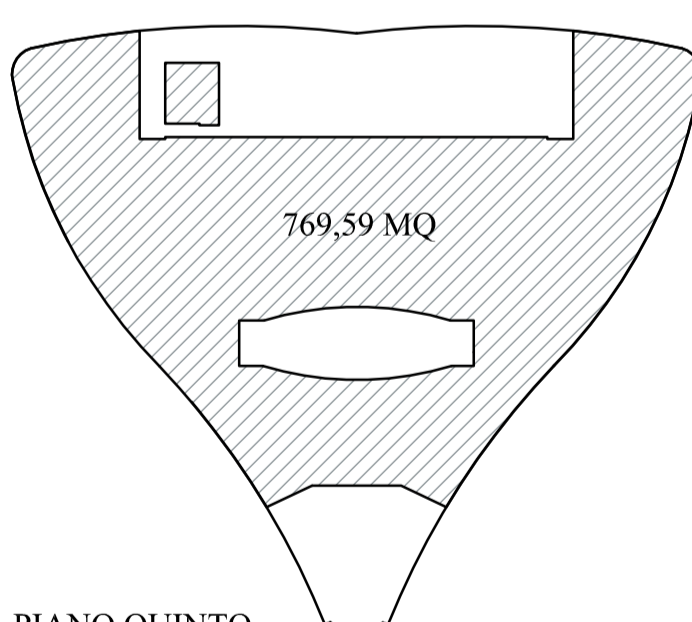

PIANO QUINTO

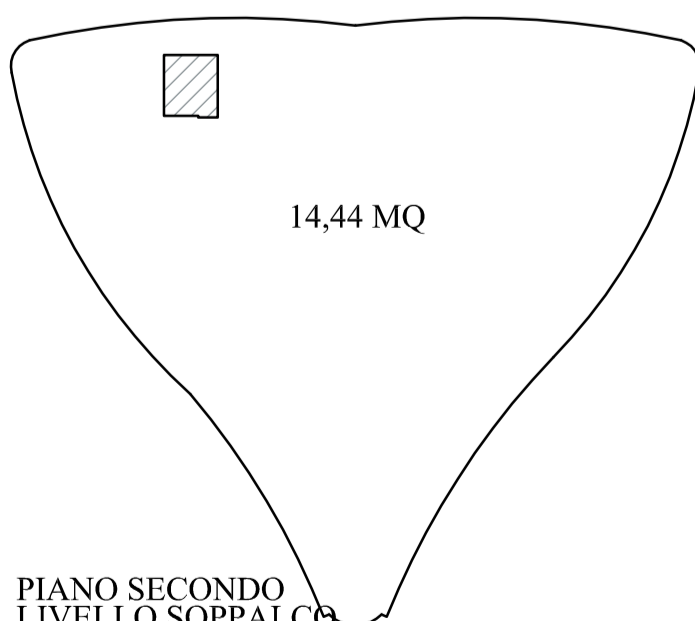

PIANO SECONDO  
LIVELLO SOPPALCO

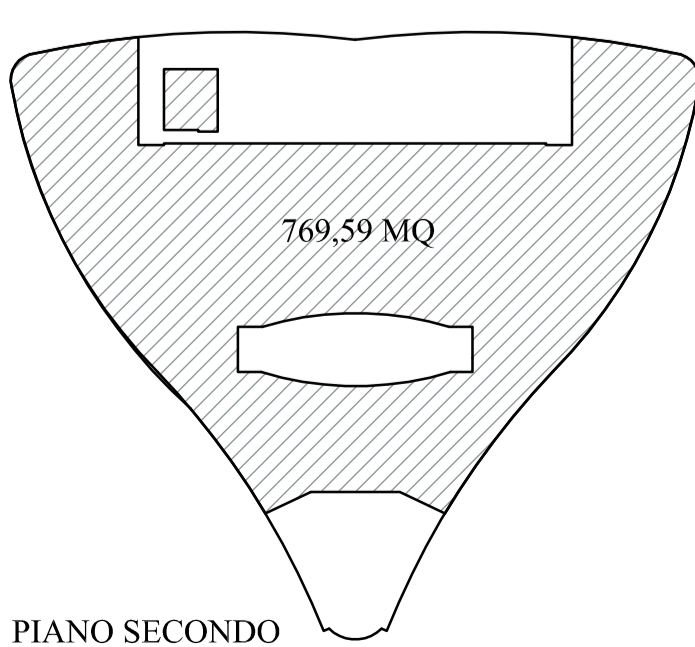

PIANO SECONDO

SUPERFICIE LORDA DI PAVIMENTO		
PIANI COMMERCIALI	P. SEMINT.	144,22 MQ
	P. TERRA	6.331,32 MQ
	P. TERRA - SOPPALCO	319,37 MQ
	P. PRIMO	6.175,48 MQ
	P. PRIMO - SOPPALCO	227,01 MQ
	P. SECONDO	769,59 MQ
	P. SECONDO - SOPPALCO	14,44 MQ
	P. TERZO	769,59 MQ
	P. TERZO - SOPPALCO	14,44 MQ
	P. QUARTO	769,59 MQ
PIANI RICETTIVI ALBERGO	P. QUARTO - SOPPALCO	14,44 MQ
	P. QUINTO	769,59 MQ
	P. QUINTO - SOPPALCO	14,44 MQ
	P. SESTO	769,59 MQ
	P. SESTO - SOPPALCO	14,44 MQ
	P. SETTIMO	769,59 MQ
	P. SETTIMO - SOPPALCO	14,44 MQ
	P. OTTAVO	769,59 MQ
	P. DECIMO	803,63 MQ
	P. UNDICESIMO	704,35 MQ
PIANI PUBBLICO ESERCIZIO RISTORANTE	P. DODICESIMO	704,35 MQ
	P. QUATTORDICESIMO	704,35 MQ
	P. QUINDICESIMO	723,31 MQ
	P. SEDICESIMO	723,31 MQ
	P. DICOTTESIMO	723,31 MQ
	P. DICIANNOVESIMO	815,18 MQ
	P. VENTESIMO	393,17 MQ
	P. VENTUNESIMO	304,15 MQ
	TOT. PIANO SEMINTERRATO	144,22 MQ
	TOT. PIANI COMMERCIALI	18.526,95 MQ
TOT. PIANI RICETTIVI - ALBERGO		5.901,79 MQ
TOT. PIANI PUBBLICO ESERC. - RISTORANTE		697,32 MQ
TOTALE COMPLESSIVO		25.270,28 MQ
25.270,28 MQ < 25.548 MQ (VEDI TAV. 03)		

FABBISOGNO STANDARD PRG - PI	
VERDE	
TOT. SP MQ 25.270,28 x 0,40 =	10.108,11 MQ
PARCHEGGI	
TOT. SP MQ 25.270,28 x 0,40 =	10.108,11 MQ
FABBISOGNO PARCHEGGI PRIVATI	
TOT. PIANO SEMINTERRATO	144,22 MQ
TOT. PIANI COMMERCIALI	18.526,95 MQ
TOT. PIANI PUBBLICO ESERC. - RISTORANTE	697,32 MQ
TOTALE	19.368,49 MQ
SP MQ 19.368,49 x 3 : 10 =	5.810,55 MQ
TOT. PIANI RICETTIVI - ALBERGO N. CAMERE 120 x 2 POSTI LETTIC	
TOT. 240 POSTI LETTIC x 5 MQ/POSTO LETTIC =	1.200,00 MQ
TOTALE FABBISOGNO PARCHEGGI PRIVATI	
MQ 5.810,55 + MQ 1.200,00 =	7.010,55 MQ
TOTALE COMPLESSIVO FABBISOGNO PARCHEGGI	
FABBISOGNO STANDARD PRG	10.108,11 MQ
FABBISOGNO PARCHEGGI PRIVATI	7.010,55 MQ
TOTALE COMPLESSIVO	17.118,66 MQ

B.L.O. IMMOBILIARE S.R.L.

MILANESE & MODENA  
ARCHITETTI ASSOCIATI  
VIA CANEVE, 61 - MESTRE - VENEZIA  
30174 - MESTRE - VENEZIA  
CONCEPT  
PROGETTO ARCHITETTONICO  
PROGETTO DISTRIBUTIVO E LAVORISTICO

ecoricerche  
ingegneria

VENETIA  
B.L.O. IMMOBILIARE S.r.l.

MILANESE & MODENA  
ARCHITETTI ASSOCIATI  
VIA CANEVE, 61 - MESTRE - VENEZIA  
30174 - MESTRE - VENEZIA  
TELEFONO +39 041 2621196  
TELEFAX +39 041 5369417  
MAIL [amministratoremoden@milanese.it](mailto:amministratoremoden@milanese.it)  
PARTITA IVA 02484760273  
CODICE FISCALE 02144860273

VENEZIA  
B.L.O. IMMOBILIARE S.r.l.

NUOVA COSTRUZIONE EDIFICIO A DESTINAZIONE  
COMMERCIALE E RICETTIVO

VIA ARDUINO VIA BOTTENIGO

CALCOLO SUPERFICIE LORDA DI PAVIMENTO

TORRE  
AMM A1

1:500

MAR 2015

SP  
A40